



Schindler 5500 MRL California Fixtures

Compliant with CA Building Code



Schindler

us.schindler.com

Schindler 5500 MRL California Fixtures

Compliant with CA Building Code

Make your elevator easy to operate for all passengers - helping them locate the elevator and get to their selected destination comfortably. High resolution indicators are easy to read, and energy-efficient operating panels are made from high-quality materials with beautiful finishing options.

Standard Landing Fixtures

Standard panels, available in white or black glass, give your elevator a contemporary look.

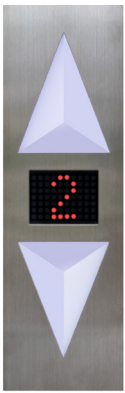

Vertical combination hall lantern and position indicator



Hall pushbuttons

Vandal-Resistant Landing Fixtures**

Protect your investment: optional vandal-resistant fixtures are engineered to withstand even the most challenging environments.

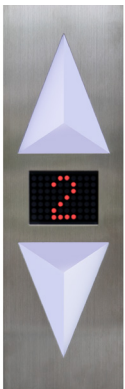

Vertical combination hall lantern and position indicator



Hall pushbuttons

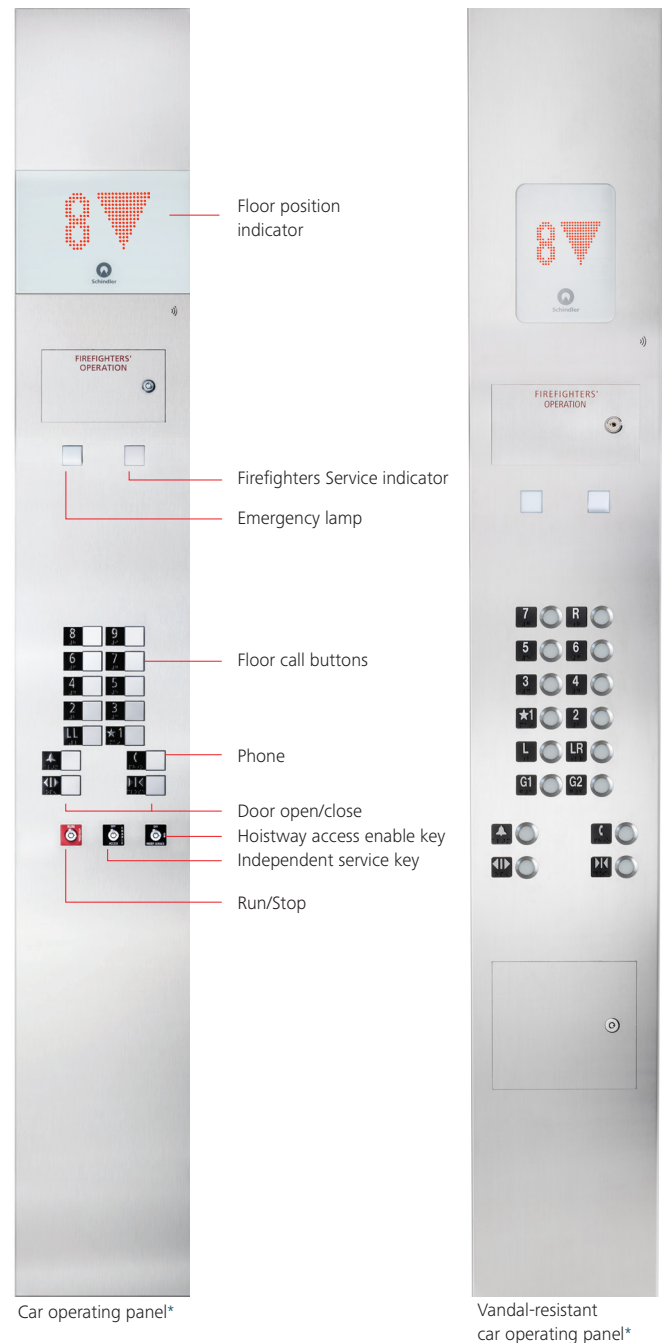

*Swing return also available.

**Vandal-resistant fixtures are available in brushed and mirrored stainless steel, as well as brushed bronze.

Schindler 5500 MRL Fixtures

Standard dimensions

Standard fixtures can be wall or jamb mounted.

Wall-mounted landing fixtures

Box cutout depth = 2 3/4" (70mm)

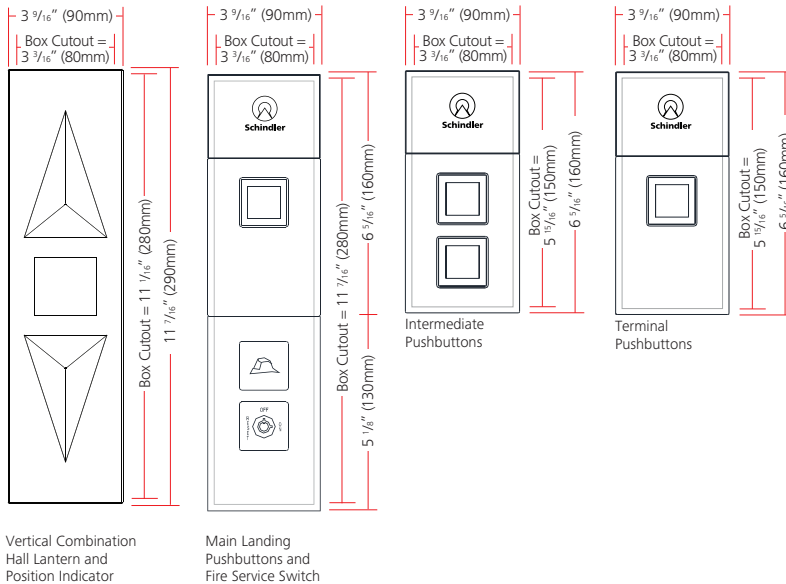

Jamb-mounted landing fixtures, flush in frame

Minimum jamb width = 4" (120mm)

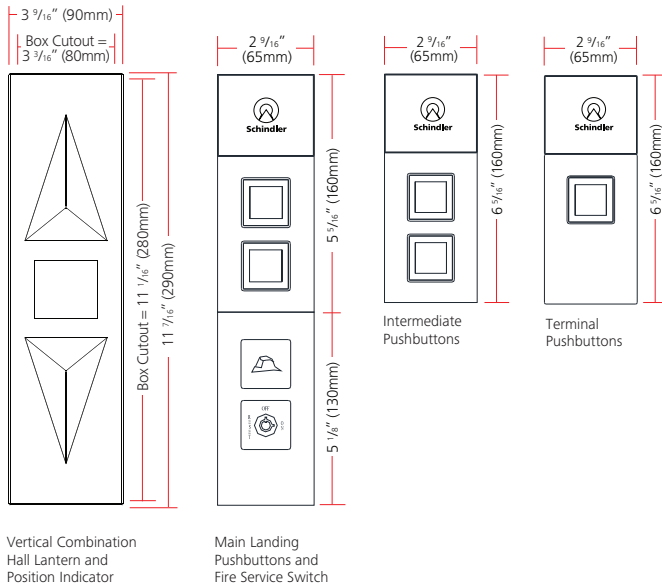

Car operating panel

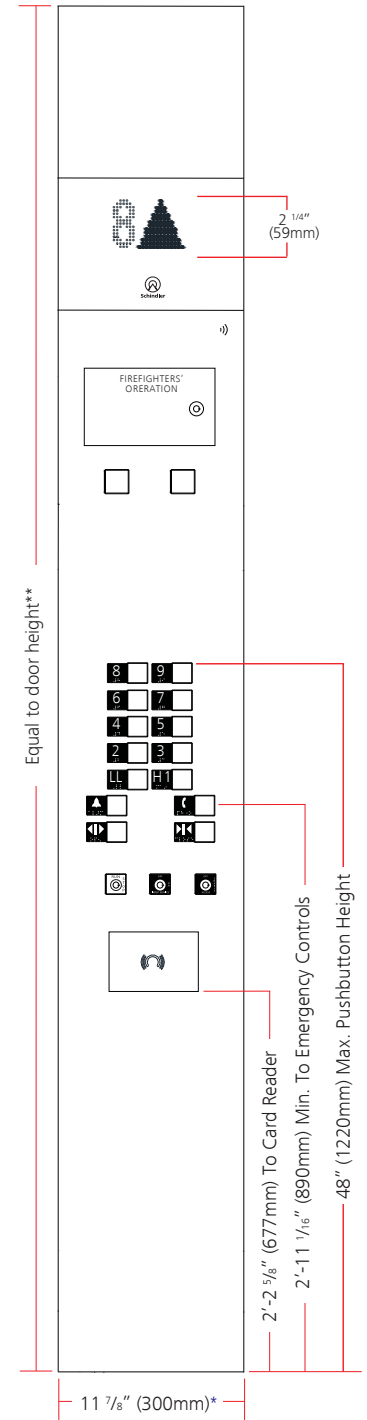

Note: Car operating panels available as full swing or flush mount. Card reader and service cabinet optional.

*Car operating panel width can be 11 7/8" (300mm) or 13 3/4" (350mm) depending on the number of buttons.

Door heights are 7' (2134mm), 8' (2438mm), or 9' (2743mm). Door height options vary by configuration, please contact your local Schindler sales representative.

Schindler 5500 MRL Fixtures

Vandal-resistant dimensions

Vandal-resistant fixtures are wall mounted.

Vandal-resistant landing fixtures

Box Cutout Depth = 3.5" (89mm)

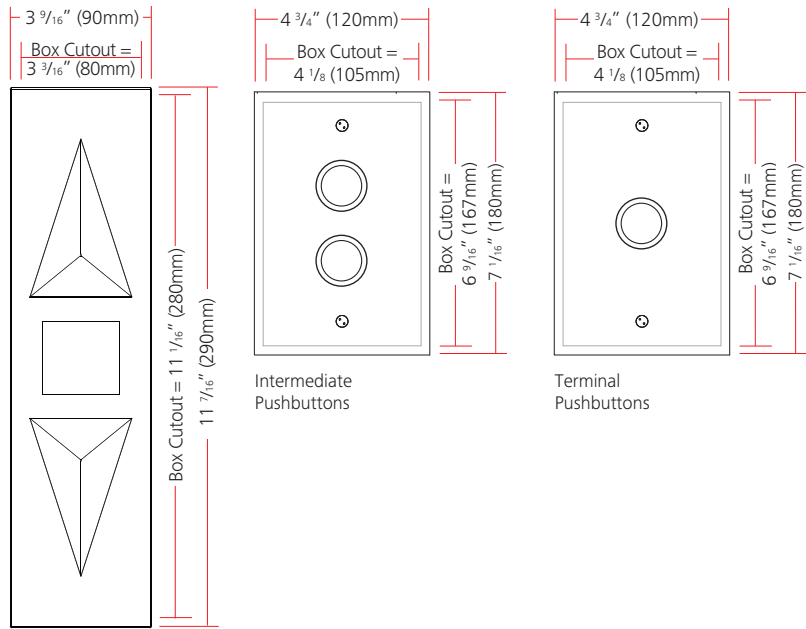

Vertical Combination
Hall Lantern and
Position Indicator

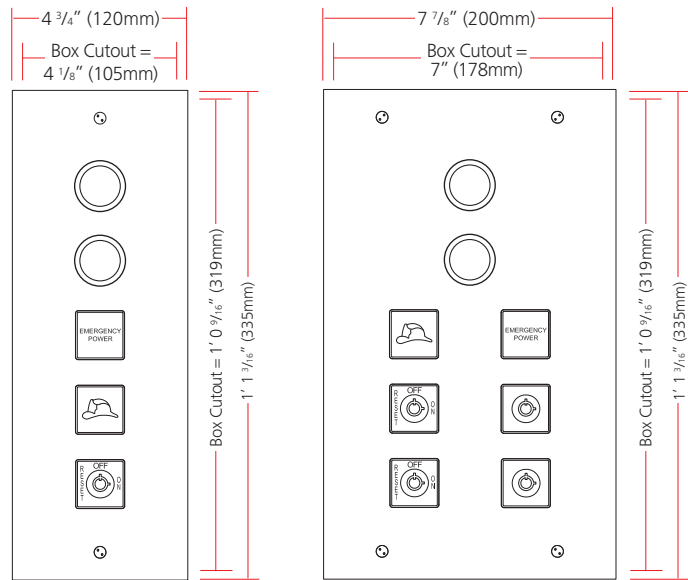

Main Landing Pushbuttons and Fire Service Switch

Vandal-resistant car operating panel

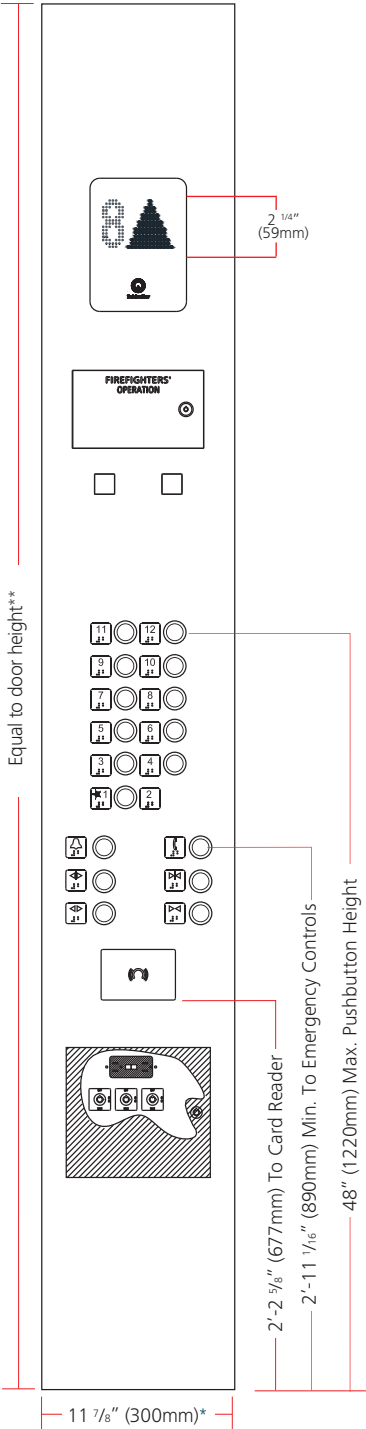

Note: Car operating panels available as full swing or flush mount. Card reader and service cabinet optional.
 *Car operating panel width can be 11 7/8" (300mm) or 13 3/4" (350mm) depending on the number of buttons.
 **Door heights are 7' (2134mm), 8' (2438mm), or 9' (2743mm). **

Schindler PORT Technology

Destination Dispatching System

Schindler's PORTs are simple, yet elegant, with a design that will set your elevator lobby apart from any other. Available as an option on the Schindler 5500, PORT comes in a variety of designs to complement any building.

Black Titanium



PORT 1



PORT 4



PORT 1 WIDE

White Aluminum



PORT 1



PORT 4



PORT 1 WIDE

Space Grey



PORT 1



PORT 4



PORT 1 WIDE

SchindlerPlan.com

Elevator and escalator design in minutes



Schindler Plan is an easy-to-use online planning tool that makes it simple to configure your elevator or escalator in minutes. Good elevator or escalator design plays a critical role in the quality of life and work in multi-story buildings. Schindler Plan was developed to enable accurate escalator or elevator preparation early in a project's life cycle.

Schindler – We Elevate

For more information, including the location of the Schindler office nearest you, please visit:

U.S. Headquarters. Morristown, New Jersey
Tel. 973.397.6500
www.us.schindler.com

Canada Headquarters. Toronto, Ontario
Tel. 416.332.8280
www.ca.schindler.com



Schindler has received renewal to ISO 9001 and ISO 14001 certificates.



Schindler prints with vegetable-based ink on paper containing post-consumer waste fiber.