



Schindler 3300 California Fixtures

We Elevate



Schindler

us.schindler.com

Schindler 3300

California Standard Fixtures

The features and components of the Schindler 3100, 3300, and 3300 XL machine room-less elevators are designed to enhance the rider experience, improve safety, and minimize downtime. From the low-energy multiprocessor controls to the stylish operating panels, you'll find the latest technological advances.

Standard car operating panel

- Stylish stainless steel and tempered safety glass
- Door open/close and alarm buttons
- Braille
- Visual and audible call confirmation
- Position indicator
- Concealed Phase II Firefighters Service operation
- Attractive, metallic-finished pushbutton

Signalizations on car operating panel



Overload protection:

Red scale-shaped icon, along with an adjustable buzzer, that provides prompting of some off-loading of passengers or items. The message is also presented as "OL" in the car floor indicator position.



Central alarm:

Yellow bell-shaped icon that is visible only if activated by an alarm request. The icon is also accompanied by the sounding of the car top buzzer.



Voice communication:

Green phone-shaped icon indicates that voice communication has been established.



Earthquake:

Red shaking building icon depicts that a seismic event has been detected.



Medical emergency service:

A blue/grey box with white lettering depicts that a medical emergency has been activated.



Evacuation:

Red cab-shaped icon that indicates that passengers should leave the cab.

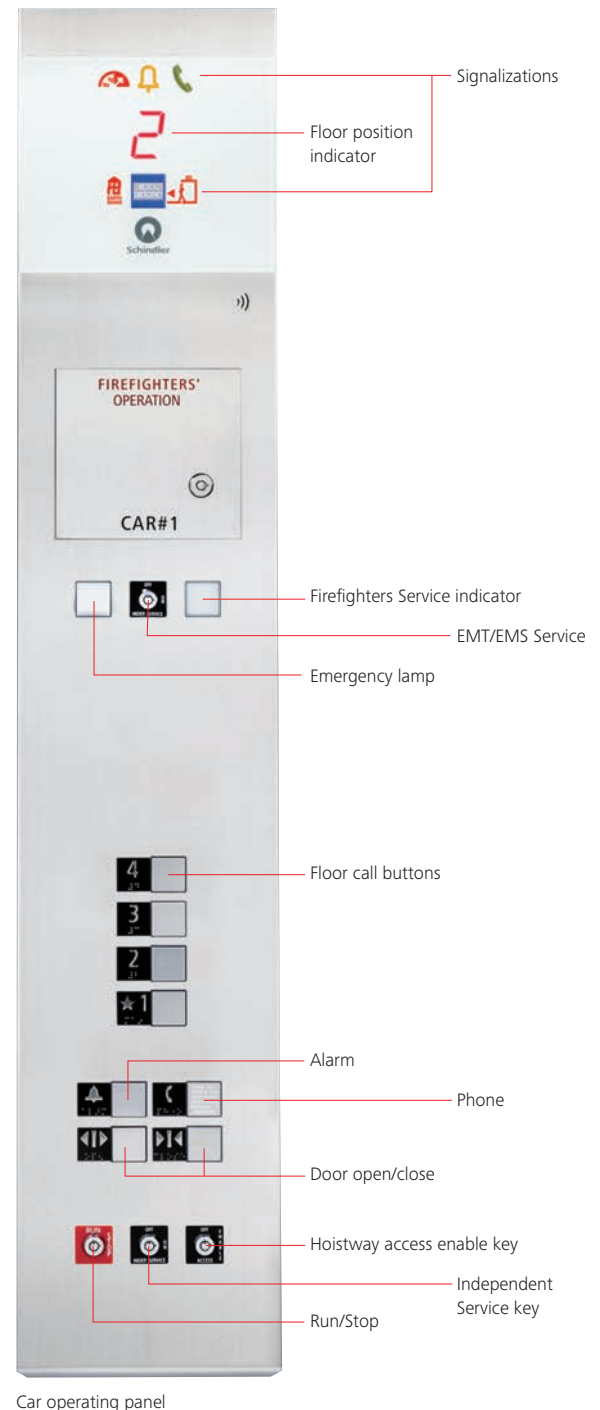

Car operating panel

Schindler 3300

California Standard Fixtures

Stylish stainless steel with tempered safety glass accents give the elevator a contemporary, modern look while meeting all applicable codes. Please refer to our deco brochure for more information on decor and accessory options.

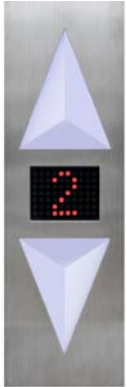

Vertical combination
hall lantern and
position indicator



Hall pushbuttons



Standard landing operating panels

- Stylish stainless steel with tempered safety glass accent, with pushbuttons
- Jamb mounted for fewer building interfaces
- Call acceptance both visual and audible
- Tactile, concave square button for positive contact assurance
- Metallic button finish.

Optional

- Wall-mounted car call buttons or landing indicator fixtures.

Note: The car specifications, options and colors in this brochure are representative only and are subject to change. Sample shown may vary from the original in color and materials.

Additional 3300 Fixtures

California Optional Fixtures

In addition to the standard fixtures there is an optional fixture line offering a full length, flush mounted car operating panel. This optional fixture line is also available in a vandal resistant design.

Vandal-Resistant Landing Fixtures***

Protect your investment: optional vandal-resistant fixtures are engineered to withstand even the most challenging environments.



Vertical combination hall lantern and position indicator



Hall pushbuttons

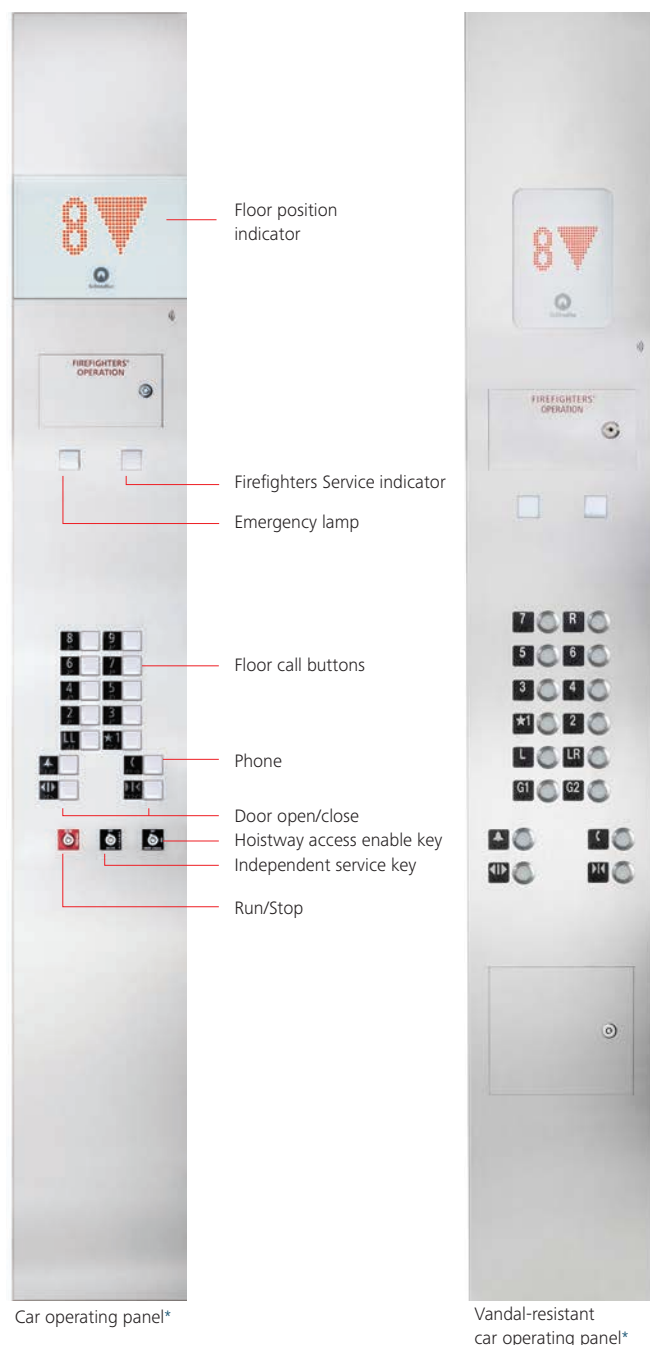

Car operating panel*

Vandal-resistant car operating panel*

***Vandal-resistant fixtures are available in brushed stainless steel.

Additional 3300 Fixtures

Dimensions

Choose your optimal landing arrangements for simplex and multiplex installations.
Standard fixtures can be wall or jamb mounted.

Wall-mounted landing fixtures

Box cutout depth = 4" (120mm)

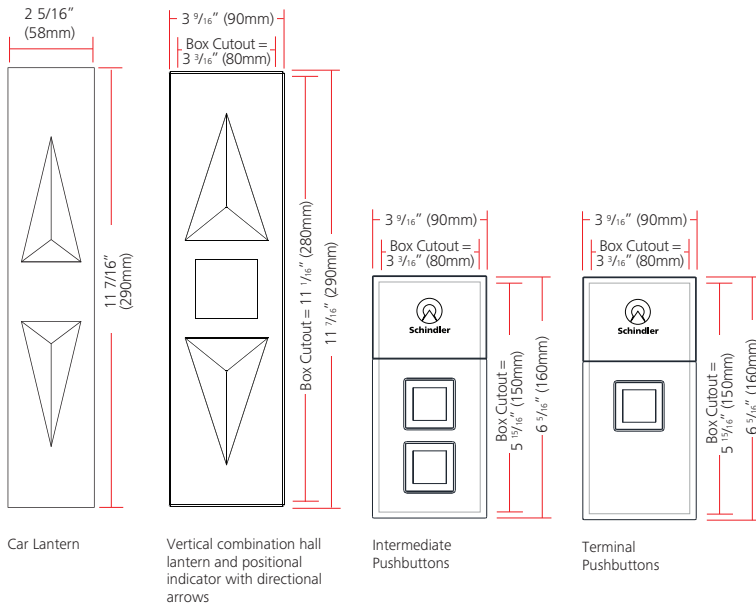

Jamb-mounted landing fixtures, flush in frame

Minimum jamb width = 4" (120mm)

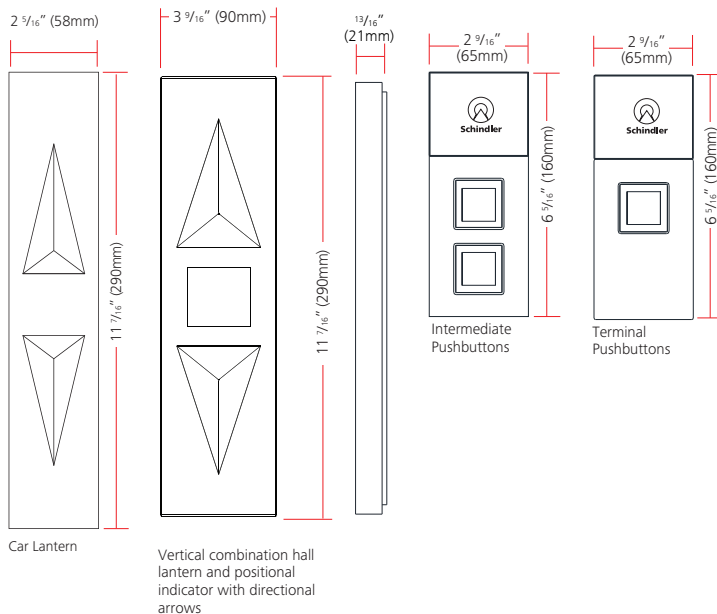

Car operating panel

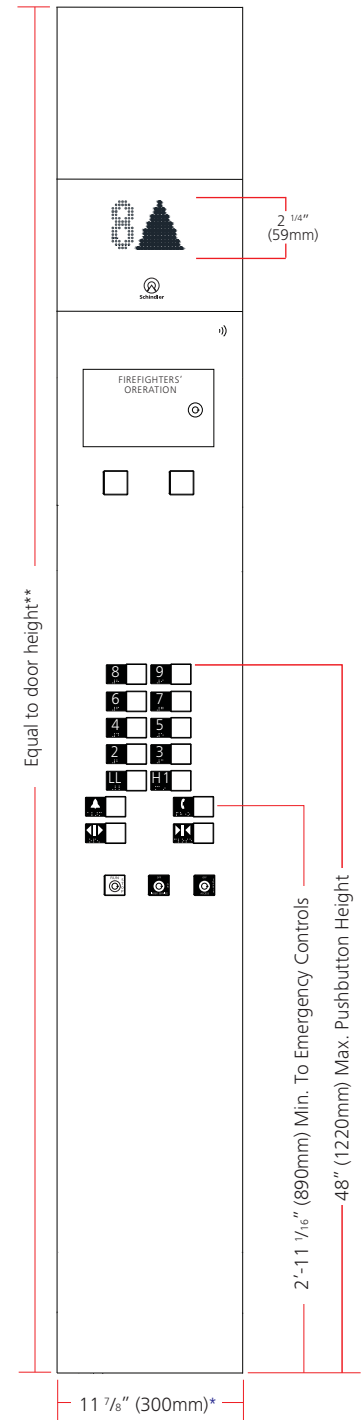

Notes:

- Car operating panels are full length and flush mounted. Surface mounted card reader optional.
- Service cabinet not a standard option, only available based on configuration.
- Car operating panel width can be 11 7/8" (300mm) or 13 3/4" (350mm) depending on the number of buttons.
- Car operating panel height may vary on Schindler Expanded 3300.
- Door heights are 7' (2134mm), 8' (2438mm), or 9' (2743mm). Door height options vary by configuration, please contact your local Schindler sales representative.

Additional 3300 Fixtures

Vandal-resistant Dimensions, On Select 3300 Configurations

Vandal-resistant fixtures are wall mounted.

Vandal-resistant landing fixtures

Box Cutout Depth = 3.5" (89mm)

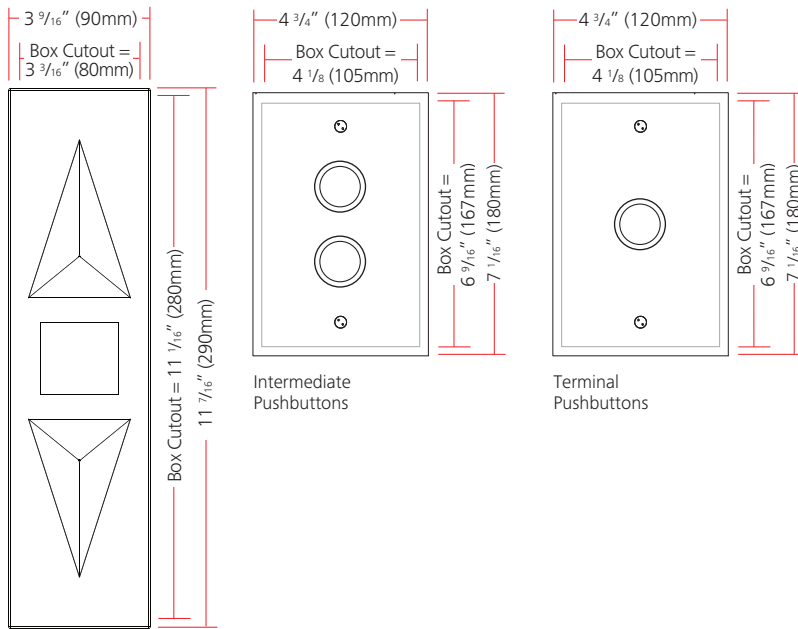

Vertical Combination
Hall Lantern and
Position Indicator

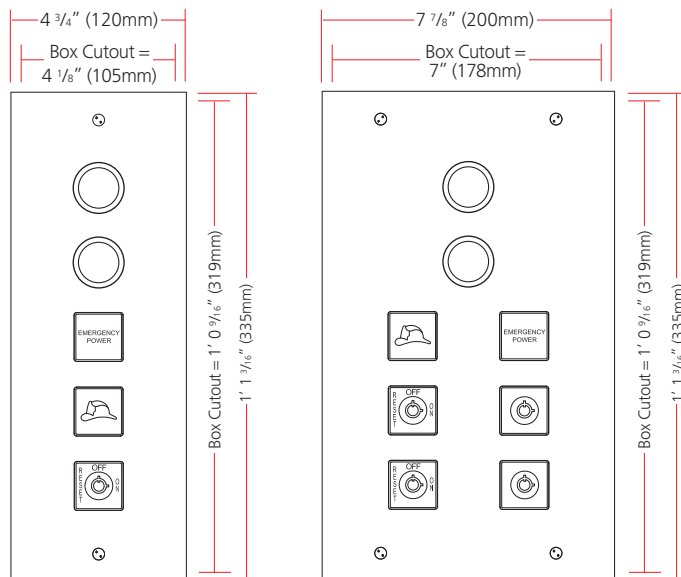

Main Landing Pushbuttons and Fire Service Switch

Notes:

- Car operating panels are full length and flush mounted. Surface mounted card reader optional.
- Service cabinet not a standard option, only available based on configuration.
- Car operating panel width can be 11 7/8" (300mm) or 13 3/4" (350mm) depending on the number of buttons.
- Car operating panel height may vary on Schindler Expanded 3300.
- Door heights are 7' (2134mm), 8' (2438mm), or 9' (2743mm). Door height options vary by configuration, please contact your local Schindler sales representative.

Vandal-resistant car operating panel

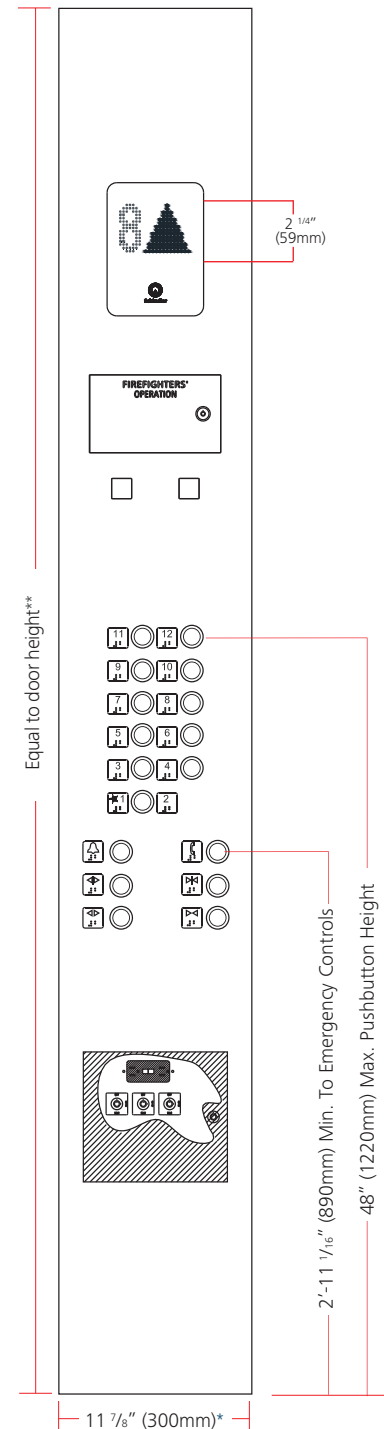



Schindler – We Elevate

For more information, including the location of the Schindler office nearest you, please visit:

U.S. Headquarters. Morristown, New Jersey
Tel. 973.397.6500
www.us.schindler.com

Canada Headquarters. Toronto, Ontario
Tel. 416.332.8280
www.ca.schindler.com

We Elevate



Schindler has received renewal to ISO 9001 and ISO 14001 certificates.



Schindler prints with vegetable-based ink on paper containing post-consumer waste fiber.
© Schindler Elevator Corporation