



# Elevator products and packages

## Transport

We Elevate



**Schindler**



## We Elevate... Traffic

We provide the means to move people to, from and through public transport systems worldwide – including airports, subways, main railway stations and more. With over 140 years of experience, we know how to design and precision-engineer our public transport elevators, escalators and moving walks to **meet all specific needs.**

# Adding personal comfort to public transport

With our mobility solutions, your facility runs like a Swiss watch. Our precision engineering helps millions of people to get there quickly, reliably and safely.

**Managing mobility.** At crowded public transport locations, people need to get from point A to B. It has to be a convenient experience – with few lines and short waiting times. To us, convenience also means reliable elevators, escalators and moving walks that are optimally located. They should be large enough to handle capacity and easy enough to operate for the disabled and passengers in a full car.

**Fast response.** With us as your partner, you can ensure public spaces stay mobile at all times. Our products are especially durable and reliable, and can be connected to your building management systems. We know how our escalators and elevators are used. We have just the right modernization solution and service package to keep them running over the long term including fast response and spare-parts delivery.

**Perfect fit.** We support you to find the right mobility solution for your public transport facility, airport or railway station. In the cabins of our large elevators, you can place the control panel almost anywhere you want. You can even have multiple control panels. We offer keyless options for your cleaning team. Our access control system lets you keep operating logistics efficiently in the background. Once you find the perfect fit, we can also assist you with fast installation.

**Tailored efficiency.** Schindler can tailor a mobility solution to your needs. If sustainability is your priority, we can tailor accordingly. Our energy-efficient products with regenerative drives can put energy back into your building's electrical grid to power other elevators or building systems. Our escalators also have eco-modes that lower operating costs.

**Seamless mobility.** We offer full traffic simulations and support with planning.

**Efficient operation.** Regenerative and LED technology for low energy consumption.

**Reliability & Service.** 24/7 service availability and fast spare parts supply, plus remote monitoring options to prevent disruptions. A dense network of service stations and certified technicians in over 1000 branches, worldwide.

**Security.** Access and destination control options for restricted areas.

**Public information.** Infotainment systems inside the car for user information.

**Tailored products.** Elevators and escalators engineered for durability and high-volume traffic, plus multiple control options.

**Variable selection.** Passenger, freight and service elevators for all purposes in public and non-public areas.

**Indoor or outdoor.** Elevators and escalators for indoor and outdoor application, and with special bump-resistant doors.

**Worry-free modernization.** From complete replacements with minimal building adaptation to tailored phased modernization, we ensure maximum traffic capacity with minimum disturbance during modernization work.

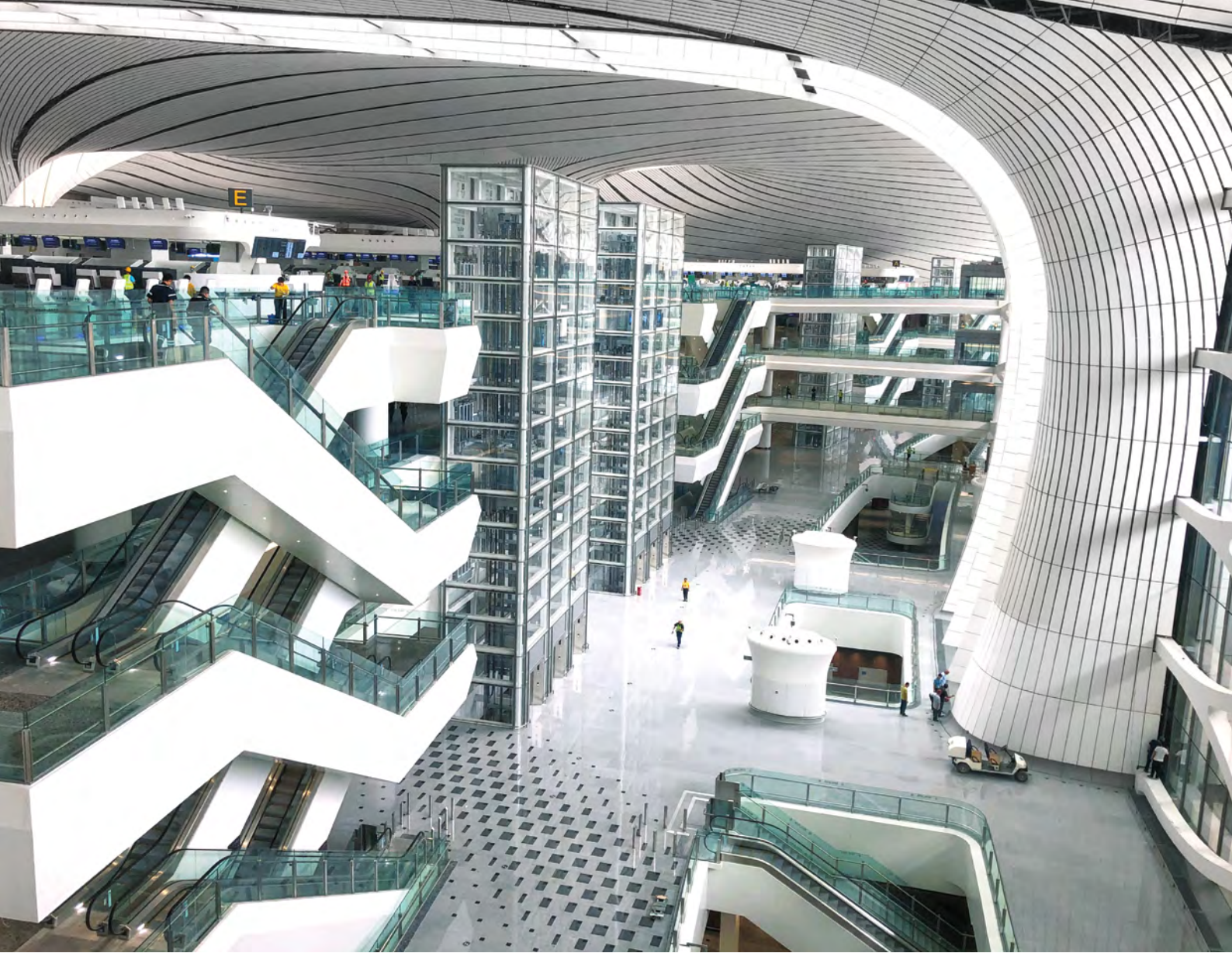

# Products and packages

## Tailored for the public transport sector

### Schindler 5000

Functionality and style taken to the next level

Schindler 5000 is the modular passenger elevator that takes reconfigurability to a new level – it uniquely combines performance, flexibility and design, which makes it easy to fit to the requirements of commercial buildings.

Capacity	680 - 2500 kg, 10 to 36 passengers
Travel height	Up to 150 m
Door width	800 to 1,400 mm
Door height	2,100 to 2,400 mm
Drive	STM Technology. Regenerative drive option
Speed	1.0 to 3.0 m/s. MRL and MMR
Number of floors	50 floors
Car groups	Up to 8 cars. Expandable with PORT Technology



### Our suggested packages

#### Schindler Easy Access Package

Let our elevators provide you with accessible mobility, for passengers with or without disabilities.

#### Schindler Security Package

Add extra security to your building by equipping your elevator with this package.



### Schindler Modernization

Want to optimize mobility in your building? We offer flexible, modern solutions to replace your existing elevator.

- Schindler 5000 Plus
- Phased modernization



### See our references

Discover our reference projects around the globe







## Your professional and trusted partner

### Services to meet your specific needs

We will partner with you to find the best mobility solution for your facility. From design through installation, and on through service, our professionals will be there for the life cycle of your building.

As your partner, we'll determine what you need and make sure you get it:

- Tailor a mobility solution to your needs. If either sustainability or energy efficiency is your priority, we can tailor a mobility solution to your needs.
- We offer smart solutions for your equipment, your passengers and you. Experienced, personalized and always accessible.
- We provide a dense network of service stations and certified technicians in over 1000 branches worldwide.

**For more information, please contact us:**

**Schindler India Pvt. Ltd.**

Schindler House, Main Street, Hiranandani Gardens Powai, Mumbai – 400076

Tel: 022 - 67031000 / 61314444

This publication is for general informational purposes only and we reserve the right at any time to alter the services, product design and specifications. No statement contained in this publication shall be construed as a warranty or condition, expressed or implied, as to any service or product, its specifications, its fitness for any particular purpose, merchantability, quality or shall be interpreted as a term or condition of any service or purchase agreement for the products or services contained in this publication. Minor differences between printed and actual colors may exist.

**We Elevate**



**Schindler**