



Schindler PORT 1

The iconic PORT terminal

We Elevate



Schindler

Schindler PORT 1

Specifications

Our iconic bent-glass destination control terminal offers passengers optimal visibility and user experience in a compact form. Select destination floors and more using the 7-inch touch display panel or access convenient and hygienic touchless operation features.

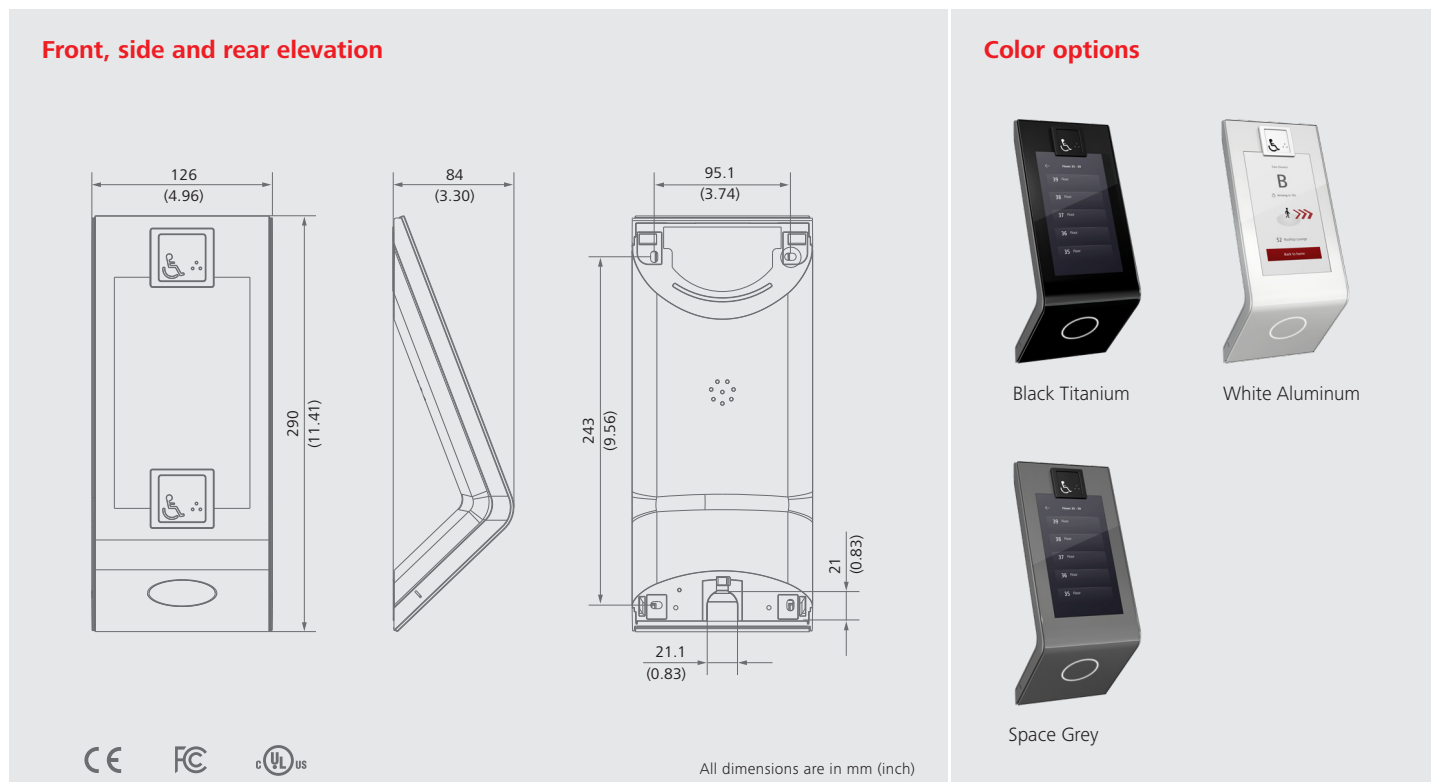

Properties and dimensions

Physical Dimensions (W×H×D)	126×290×84 mm (4.96×11.41×3.30 inch)
Power Supply	24–48 VDC or PoE (IEEE 802.3af)
Power Consumption	max. 9 W per unit
Standby Mode	Yes, triggered by proximity sensor
Range of Application	Temperature: 0 to 45 °C (14 to 113 °F) Humidity: 0 to 90% non-condensing Indoor use only
Mounting Height	The centerline of the Accessibility button is 1100 mm (43.3 inch) above the finished floor level (FFL) – button at top configuration
Screen	7" display, 600×1024 pixel, touch panel
Touchless Operation	myPORT, myPORT QR
QR Code Camera	Optional (as PORT 1 QR)
Card Reader	Supports all common RFID tags (all tags must be prequalified by our test service center prior to installation)
Accessibility Button	Optional, top or bottom

Schindler Management Ltd.
Zugerstrasse 13
6030 Ebikon
Switzerland
+41 41 445 30 60

www.schindler.com

We Elevate

This publication is for general informational purposes only and we reserve the right at any time to alter the product design and specifications. No statement contained in this publication shall be construed as a warranty or condition, expressed or implied, as to any product, its fitness for any particular purpose, merchantability, quality or shall be interpreted as a term or condition of any agreement regarding the products or services contained in this publication. Minor differences between printed and actual colors may exist.

Copyright © 2022 Schindler Aufzüge AG